

Inline asynchronous circulators for heating application

Type: Wilo AC RS 25/5-3 180 mm



- Wilo AC/STAR RS Circulators are optimal for Hot water supply & can be used as a spare part in various heat generators
- Wet-runner circulating pump with manual 3-stage speed control and anti-blocking current AC motor.
- Cast iron pump housing with cataphoretic coating. Impeller made of GF polypropylene.
- Stainless steel shaft with graphite plain bearings.

Technical specifications:

Medium temperature: max. 95 ° C

Test mark: VDE, GS, CE

Operating pressure: max. 6 bar

Pipe connection: Rp 1 / G 1 1/2 "

Installation length: **180 mm**

Power levels switchable: 39W / 59W / 84W

Lifting height: approx. 5m

Power connection: 220V / 60HZ (protection class: IP44)

Insulation class: F

Weight Approx. : 2.8 kg

Inline asynchronous circulators for heating application

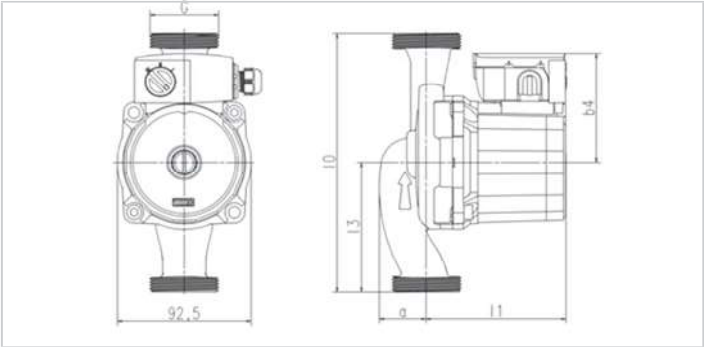

Dimensions & Technical details:

	Thread	Dimensions				
	G	I0	I3	I1	a	b4
RS 25/2/4/5-NY.13/33/43	1"1/2	180	90	96,6 96,6 96,6 109,6	33	72,5 76 72,5 76

	n l/m	P1 W	I A	Capacitor µf /VDB
RS../5 NX../43 NY../43	max	2200	88	0,38
		2000	60	0,27
	min	1600	40	0,18
				2 / 400

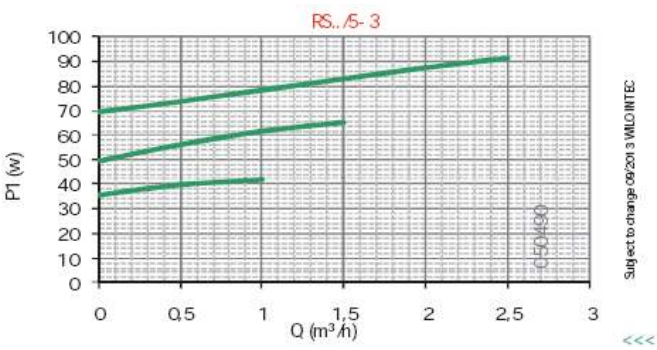
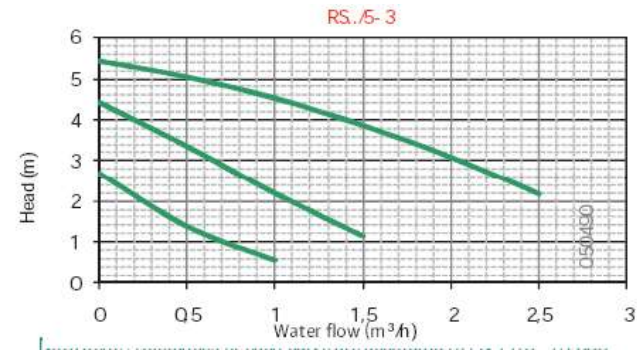

Tolerances of each curve are according to EN1151-1/2006